

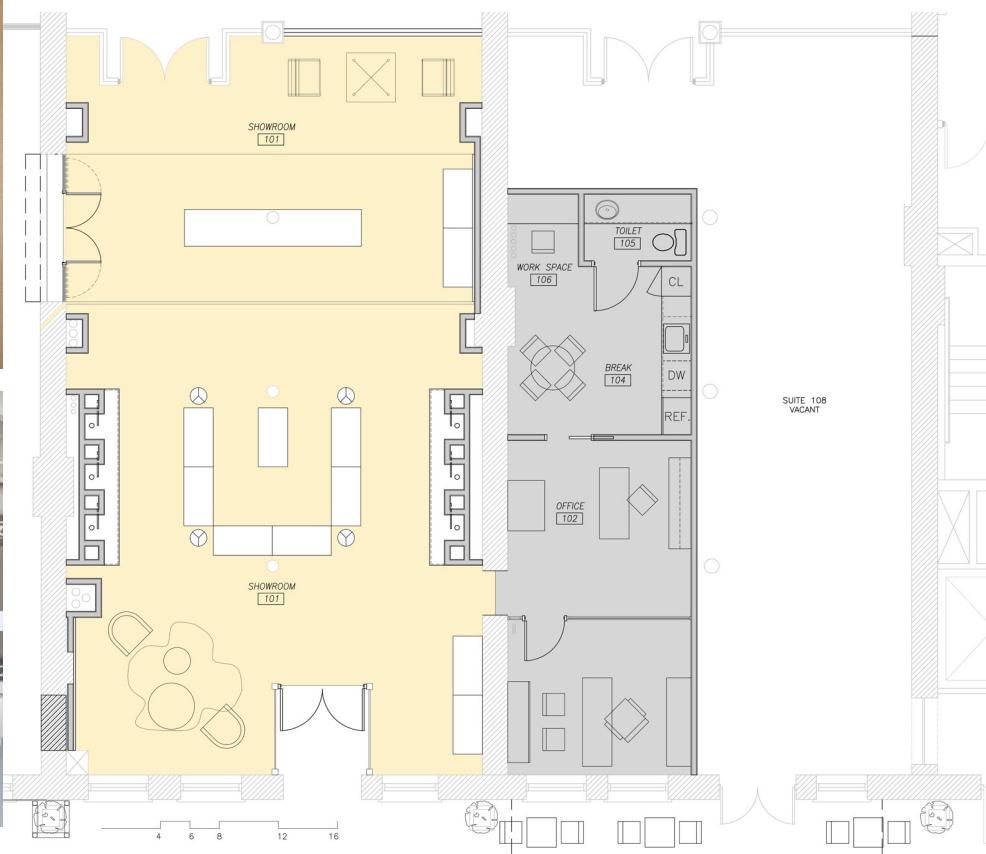

AMANDA PINSON JEWELRY

Amanda Pinson developed a love for glamour in her formative years watching her mother model in New York and living in a family that dressed for dinner and parties. She wanted to capture a sense of the time when life was slower and more elegant. She also wanted to create a warm and inviting space where people would not be intimidated by jewelry and that at the same time would be a backdrop for the lushness that jewelry is all about.

The team of architect, designer and owner worked together to bring this program to life. A simple palette of all white materials to create the neutral backdrop and a sense of elegance, the large photo of Greta Garbo given to the client by her grandmother is a nod to the glamour days. We used mirrors for light and movement. It is a backdrop for the lushness of the jewels, stones and people.



Being located in a refurbished urban mall with retailers who share a client base affected the design connectivity and openness. This symbiotic relationship creates an unusual freedom and openness that enhances the shopping experience.

